

## Service Instructions:

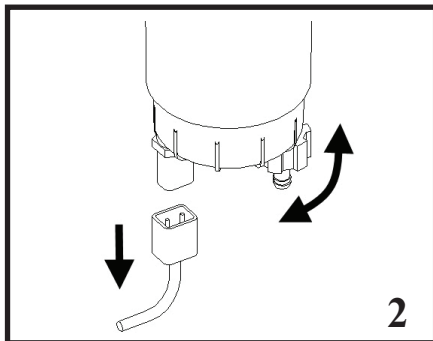

2

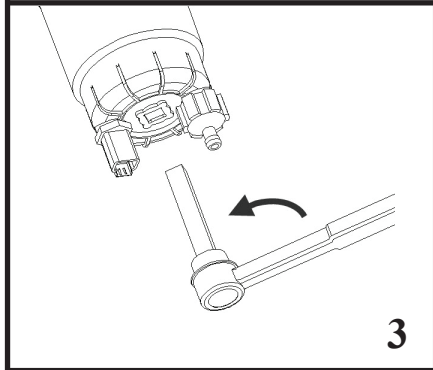

3

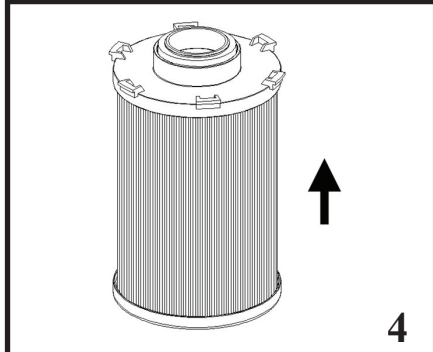

4

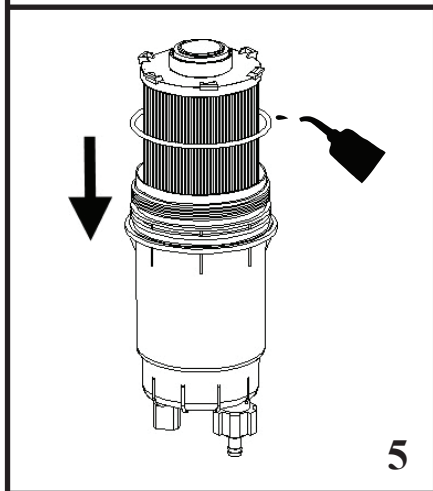

5

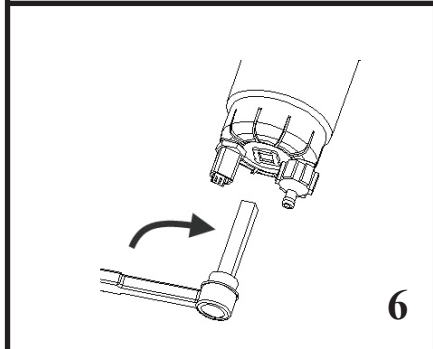

6

1. Turn engine off.
2. Drain all fluid from the filter canister:
  - a. Loosen drain valve.
  - b. Collect and dispose of fluid.
  - c. Close valve and tighten by hand. Do not use tools.
  - d. Disconnect electrical plug from the Water In Fuel (WIF) Sensor.
3. Remove the filter canister from the base:
  - a. Use a 3/4" socket or 1/2" square drive on bottom of filter canister as needed.
  - b. Do not use a strap wrench as it may damage the canister.
  - c. Ensure that the inner filter gasket is removed with the used filter cartridge.
4. Remove the filter cartridge from the canister:
  - a. Remove the filter cartridge by hand or pliers.
  - b. Do not pry against the canister as damage could result.
  - c. Remove the O-ring from canister and discard.
  - d. Check the canister for debris and rinse with clean fuel if needed.
5. Reassemble the canister and new filter cartridge:
  - a. Insert the new filter cartridge into the canister.
  - b. Lubricate the new O-ring with clean engine oil.
  - c. Install the O-ring onto the canister.
6. Install the canister with the new filter cartridge on the engine:
  - a. Do not prefill the canister with fuel. Unfiltered fuel may damage the fuel system. It is best to allow the in-tank fuel pump to prime the fuel system. See step 7.
  - b. Rotate until the canister flange first contacts the base.
  - c. Using 3/4" socket or 1/2" square drive, tighten an additional 1/2" of rotation.
  - d. Reconnect electrical plug to WIF sensor.
7. Prime fuel system and start engine:
  - a. Crank the engine 1 to 2 seconds.
  - b. Leave key in run position for 25 seconds.
  - c. Start the engine.
  - d. Repeat 7a – 7c until engine starts.
  - e. Check the canister for leaks.